

▶ Gas Spring - NFS-S5-0042 Series

Code	Stroke mm	L mm (± 0.25)	C mm (-0.2)	Initial Kg (N)	End Force Kg (N)
NFS-S5-0042	6	56	50	428 (4200)	713 (7000)
	10	70	60		703 (6900)
	16	91	75		703 (6900)
	25	120	95		703 (6900)
	32	140	108		774 (7600)
	40	165	125		774 (7600)
	50	195	145		774 (7600)

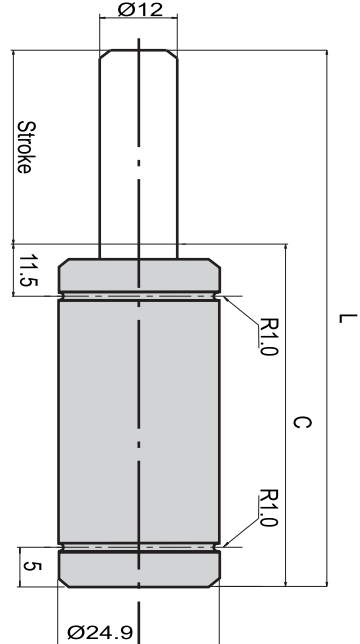

▶ Charging Pressure / Force Increase Factor

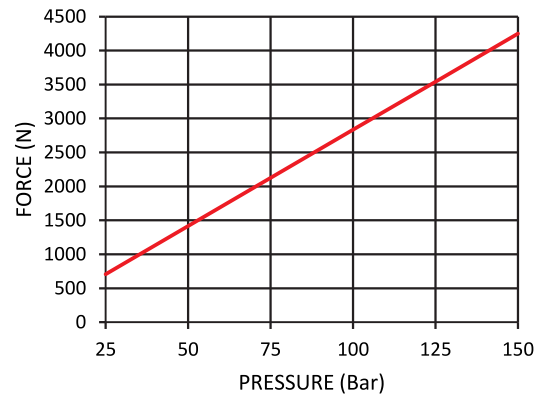
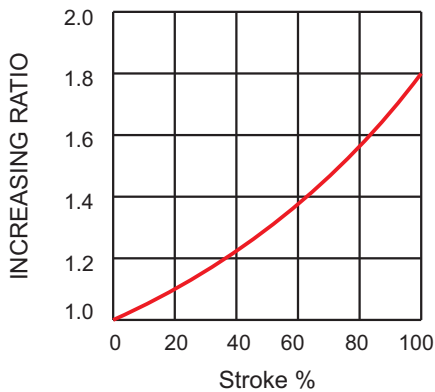

▶ Gas Spring Mountings



25 - TPC(A/B)
Ref Page No.96

▶ Gas Spring - NFS-S5-007 Series

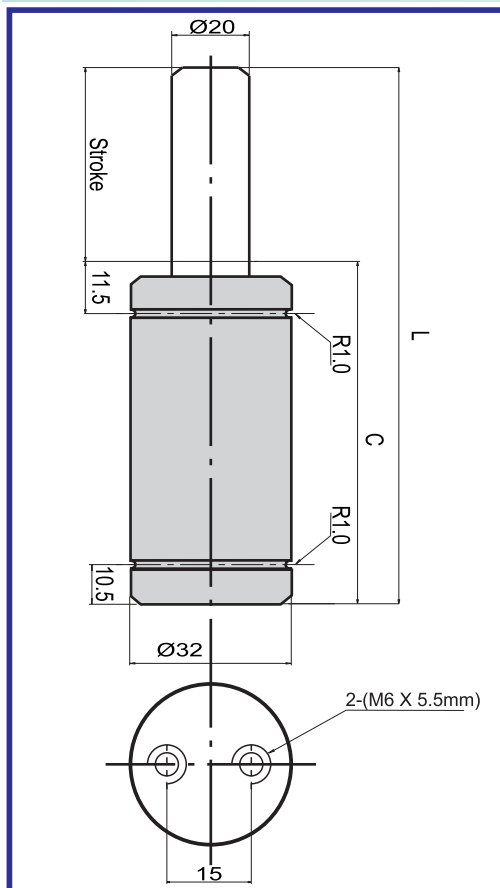

Code	Stroke mm	L mm (± 0.25)	C mm (-0.2)	Initial Kg (N)	End Force Kg (N)
NFS-S5-007	6	63	57	754 (7400)	998 (9800)
	10	75	65		1019 (10000)
	16	93	77		1121 (11000)
	25	120	95		1223 (12000)
	32	140	108		1223 (12000)
	40	165	125		1223 (12000)
	50	195	145		1223 (12000)

▶ Charging Pressure / Force Increase Factor

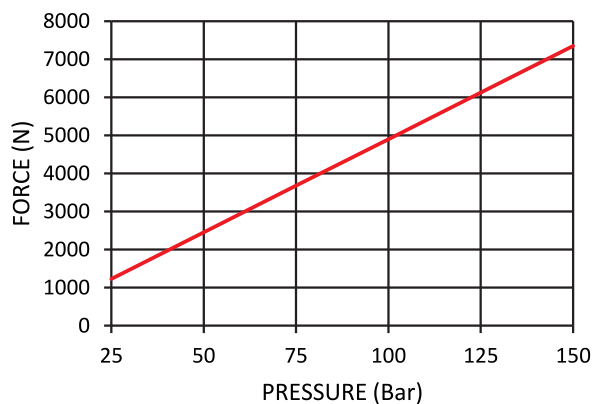
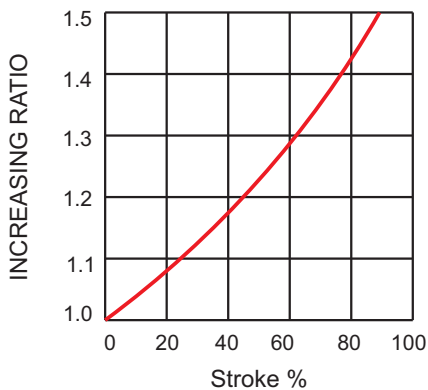

▶ Gas Spring Mountings



32 - TPC
Ref Page No.99



32 - STPC
Ref Page No.98

▶ Gas Spring - NFS-S5-010 Series

Code	Stroke mm	L mm (± 0.25)	C mm (-0.2)	Initial Kg (N)	End Force Kg (N)
NFS-S5-010	6	61	55	1080 (10600)	1631 (16000)
	10	78	68		1631 (16000)
	16	100	84		1631 (16000)
	25	135	110		1631 (16000)
	32	167	135		1631 (16000)
	40	195	155		1631 (16000)
	50	230	180		1631 (16000)

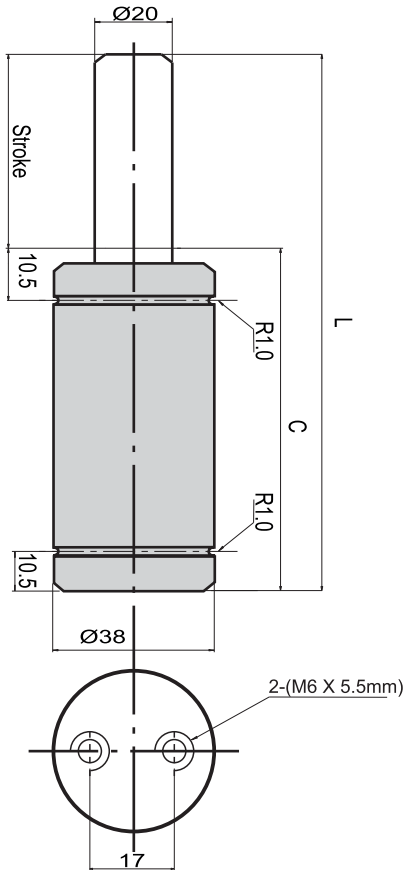

▶ Charging Pressure / Force Increase Factor

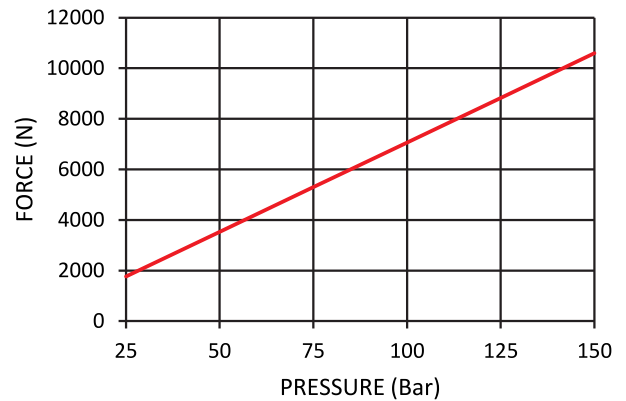
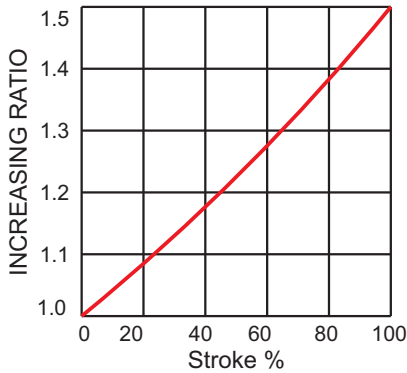

▶ Gas Spring Mountings



38 - TPC
Ref Page No.99



38 - STPC
Ref Page No.98

▶ Gas Spring - NFS-S5-018 Series

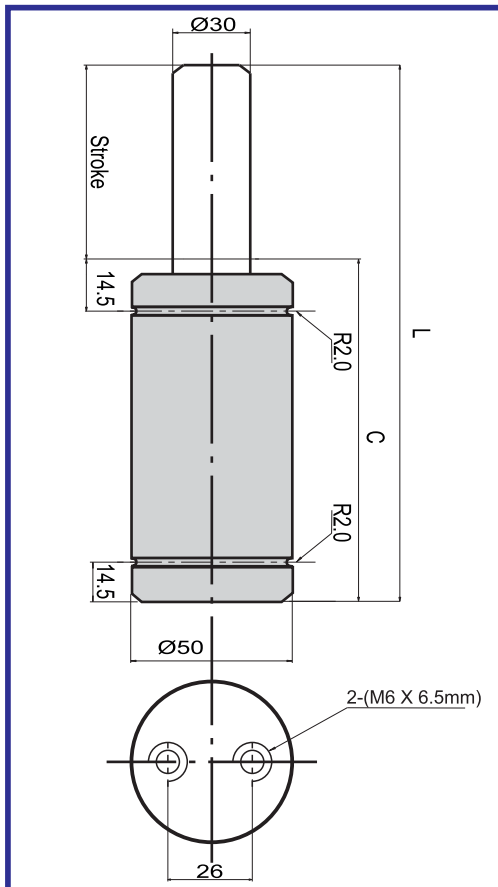

Code	Stroke mm	L mm (± 0.25)	C mm (-0.2)	Initial Kg (N)	End Force Kg (N)
NFS-S5-018	6	66	60	1835 (18000)	2548 (25000)
	10	80	70		2548 (25000)
	16	106	90		2548 (25000)
	25	135	110		2548 (25000)
	32	162	130		2548 (25000)
	40	190	150		2548 (25000)
	50	220	170		2548 (25000)

▶ Charging Pressure / Force Increase Factor

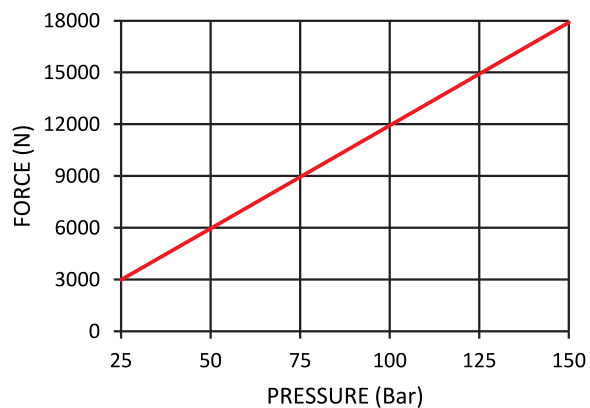
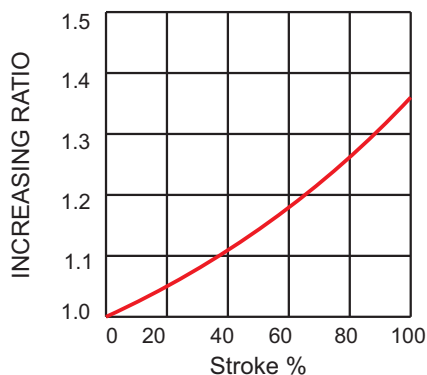

▶ Gas Spring Mountings



50 - TPC
Ref Page No.99



50 - STPC
Ref Page No.98

▶ Gas Spring - NFS-S5-029 Series

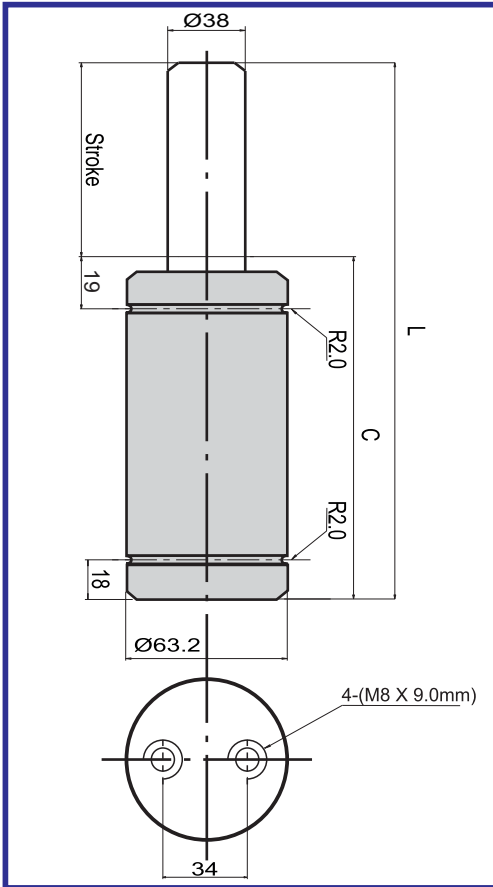

Code	Stroke mm	L mm (± 0.25)	C mm (-0.2)	Initial Kg (N)	End Force Kg (N)
NFS-S5-029	10	85	75	3007 (29500)	3924 (38500)
	16	103	87		4179 (41000)
	25	130	105		4383 (43000)
	32	150	118		4505 (44200)
	40	175	135		4607 (45200)
	50	205	155		4668 (45800)

▶ Charging Pressure / Force Increase Factor

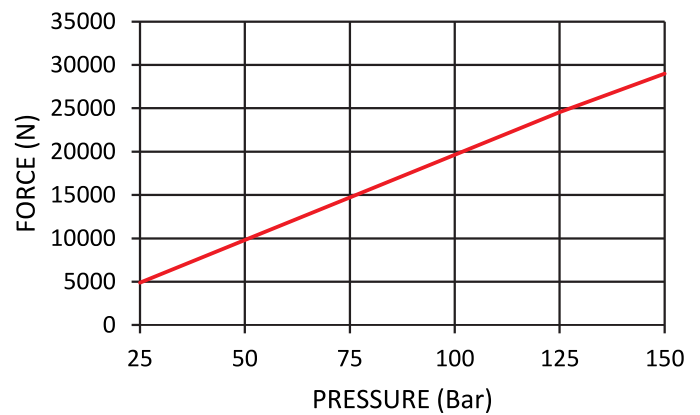
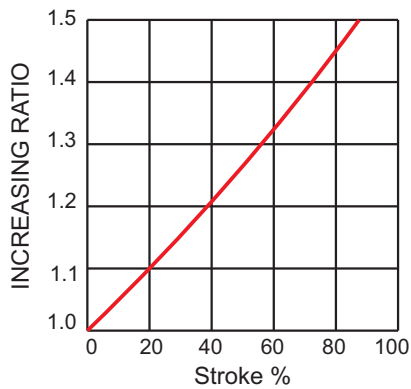

▶ Gas Spring Mountings



63 - TPC
Ref Page No.99



63 - STPC
Ref Page No.98

▶ Gas Spring - NFS-S5-047 Series

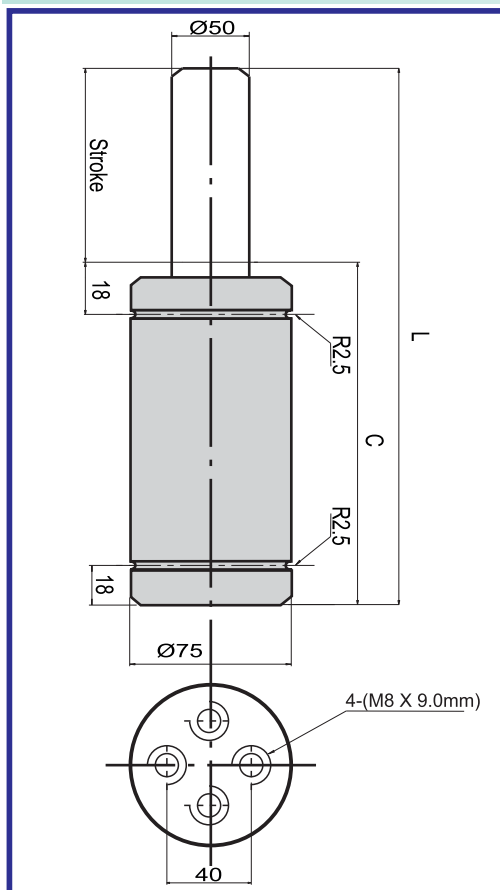

Code	Stroke mm	L mm (± 0.25)	C mm (-0.2)	Initial Kg (N)	End Force Kg (N)
NFS-S5-047	10	80	70	4791 (47000)	6829 (67000)
	16	106	90		6829 (67000)
	25	135	110		6829 (67000)
	32	167	135		6829 (67000)
	40	200	160		6829 (67000)
	50	240	190		6829 (67000)

▶ Charging Pressure / Force Increase Factor

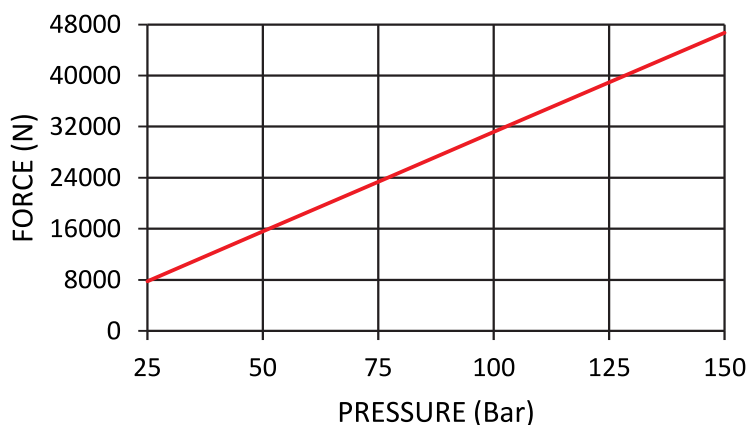
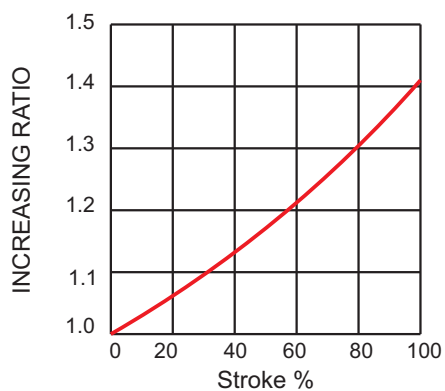

▶ Gas Spring Mountings



75 - TPC
Ref Page No.99



75 - STPC
Ref Page No.98

▶ Gas Spring - NFS-S5-075 Series

Code	Stroke mm	L mm (± 0.25)	C mm (-0.2)	Initial Kg (N)	End Force Kg (N)
NFS-S5-075	10	90	80	7645 (75000)	10601 (104000)
	16	116	100		10601 (104000)
	25	145	120		11111 (109000)
	32	182	150		10703 (105000)
	40	210	170		10907 (107000)
	50	255	205		10800 (106000)

▶ Charging Pressure / Force Increase Factor

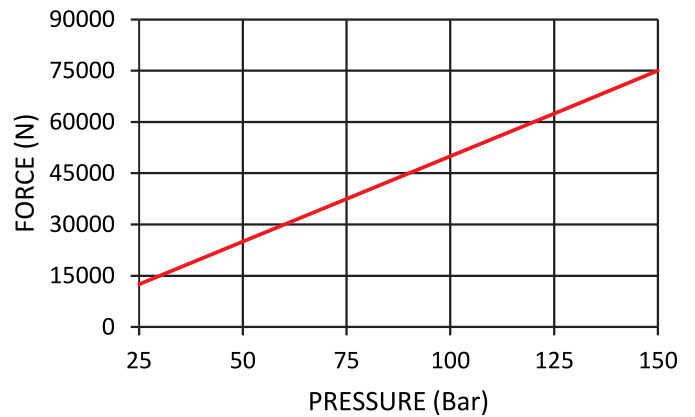
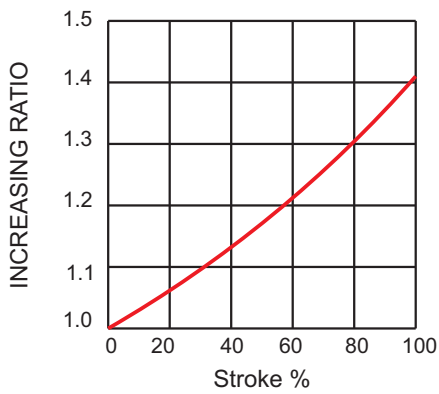

▶ Gas Spring Mountings



95 - TPC
Ref Page No.99



95 - STPC
Ref Page No.98

▶ Gas Spring - NFS-S5-118 Series

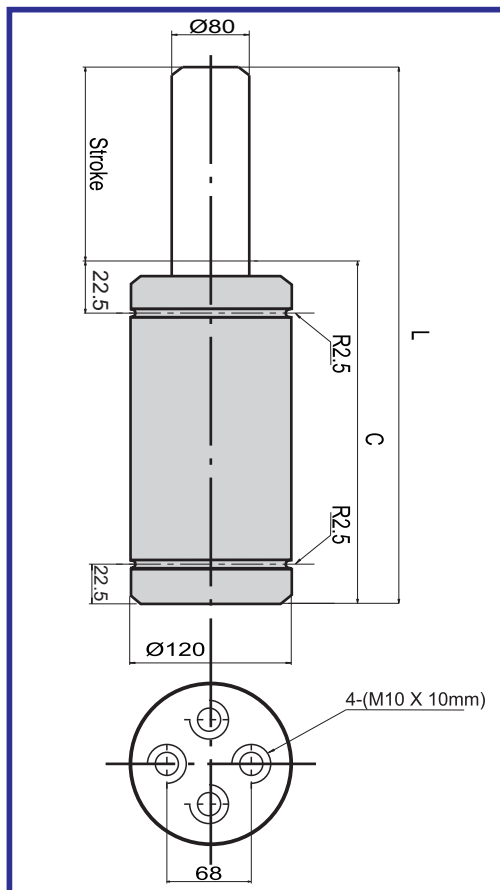

Code	Stroke mm	L mm (± 0.25)	C mm (-0.2)	Initial Kg (N)	End Force Kg (N)
NFS-S5-118	10	100	90	12028 (118000)	16361 (160500)
	16	126	110		15698 (154000)
	25	155	130		16412 (161000)
	32	187	155		16819 (165000)
	40	220	180		16412 (161000)
	50	260	210		16462 (161500)

▶ Charging Pressure / Force Increase Factor

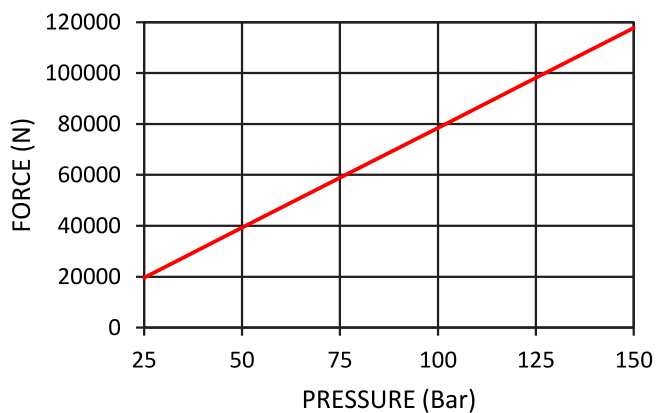
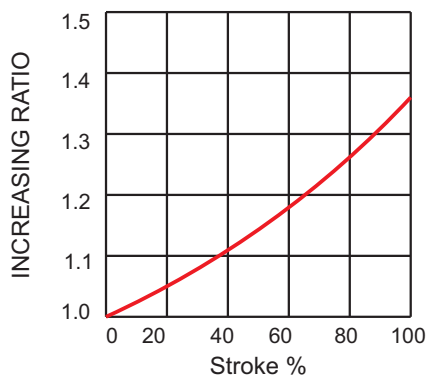

▶ Gas Spring Mountings



120 - TPC
Ref Page No.99



120 - STPC
Ref Page No.98